

700935/USW
Brushed Nickel



700930/USW
Chrome



700936/USW
Matte Black



700932/USW
Matte Graphite



700934/USW
Brushed Gold

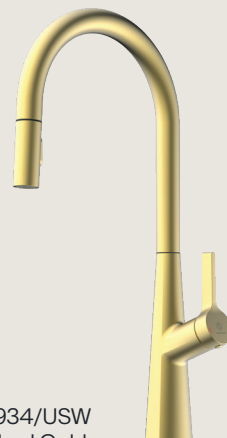

Keid Sphere Pull-Down Faucet

Specifications

Practical cold-start function for energy saving

Pull-down spout with 2 sprays

Easy assembly due to central fixing nut

Flexible metal connection hoses approx. 39.37"

Connection type: High pressure

Swivel range: 360°

Flow Rate: 1.75 gpm

Hole count: 1 to 3 (base plate available separately)

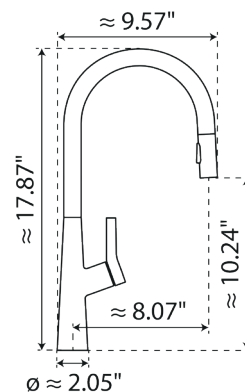

Codes & Standards

- California Energy Commission (CEC)
- Department of Energy (DOE)
- ASME A112.18.1/CSA B125.1
- NSF/ANSI/CAN 61
- ADA Compliance
- NSF/ANSI 372
- MASS